



100 years
care for all.



ST. CHARLES AT 100: A LEGACY OF GIVING

EARLY DAYS

On Christmas Day in 1917, five Sisters from Indiana boarded a train and set out to found Bend's first hospital. The simple mission — to care for all.

Through 100 years of growth and change, St. Charles has transformed from a tiny house on the Deschutes River to the health system our community depends on today.

1910: Under 10 beds, population 536

1918: 14 beds, population 4,500



GROWING WITH THE COMMUNITY

In 1922, the hospital — well beyond capacity — moved to a new building on Franklin Avenue largely funded by the Mother House in Indiana on land donated by Father Luke Sheehan of St. Francis church. Several expansions followed to respond to rapid growth.

1922: 30 beds, county population, 9,500

1951: 60 beds, county population, 22,000

1970: 99 beds, county population, 30,500

FINDING A NEW HOME

Sister Catherine Hellmann, St. Charles CEO 1969–2001, led the effort to find a location that would accommodate the population and leave room for future growth.

St. Charles Medical Center, in its current location on Neff Road, was dedicated in September of 1975.

1975: 164 Beds, county population, 50,000



LAUNCHING OUR NEXT



Our community has always supported St. Charles,

1922

Land on Franklin Avenue and funding donated to build the new facility on Hospital Hill.

1948

After WWII, massive overcrowding spurred the community to raise \$323,000 for a new hospital.

1972

Citizens support \$12 million in tax-free bonds for the construction of St. Charles Medical Center.

1991

Community raises \$2.5 million for capital improvements

XT CENTURY OF CARE



ST. CHARLES EXPANSION

- Three stories
- 24-bed ICU
- 28-bed inpatient unit
- 300 added parking spots
- Second water line

so St. Charles can in turn support the community.

2000

Community raises more than \$4 million for wellness and self-care programs.

2006

Community raises \$10 million for Family Birthing Center expansion and NICU in Bend.

2014

Community raises \$5.7 million for the new, integrated Cancer Center at St. Charles Bend.

2018

It's our time to join together for the health of our growing community and the next century of care.

PLANNING FOR THE FUTURE

OUR CHALLENGE TODAY

2018: 259 beds, county population, 175,000

Deschutes is the third fastest growing county in the nation, and Central Oregon has grown by 63,000 people in the past 25 years. The population of our service area is estimated to double in 50 years.

St. Charles Bend is beyond capacity. Nine out of 10 inpatient beds are occupied most days, and the ICU was forced to transfer nearly 200 patients for lack of beds last year.

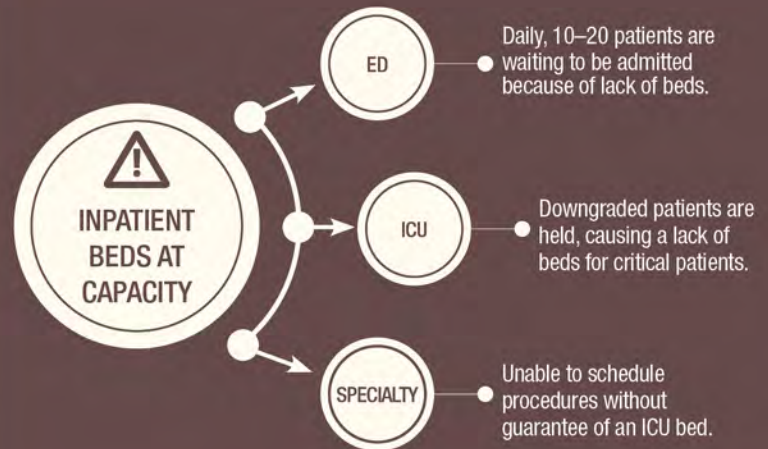

ICU CURRENT CONDITIONS

Built in 1973, our ICU rooms are undersized at 44 percent smaller than recommended. During critical crisis moments, there is not enough space for caregivers, limited space for equipment, no room for family to stay and frequent interruptions.

In addition, crowded hallways obstruct line of site and access to patients putting caregivers, patients and family at risk of injury.

CARE FOR ALL

Philanthropy has been crucial in each and every expansion at St. Charles for the past 100 years.

As our community has grown, St. Charles has grown with it.

To launch the next century of care, we're bringing our community together once again to ensure exceptional care.

Project Cost: \$66 Million

Philanthropic Support: \$10 Million



CAREGIVER, PATIENT, FAMILY DESIGNED

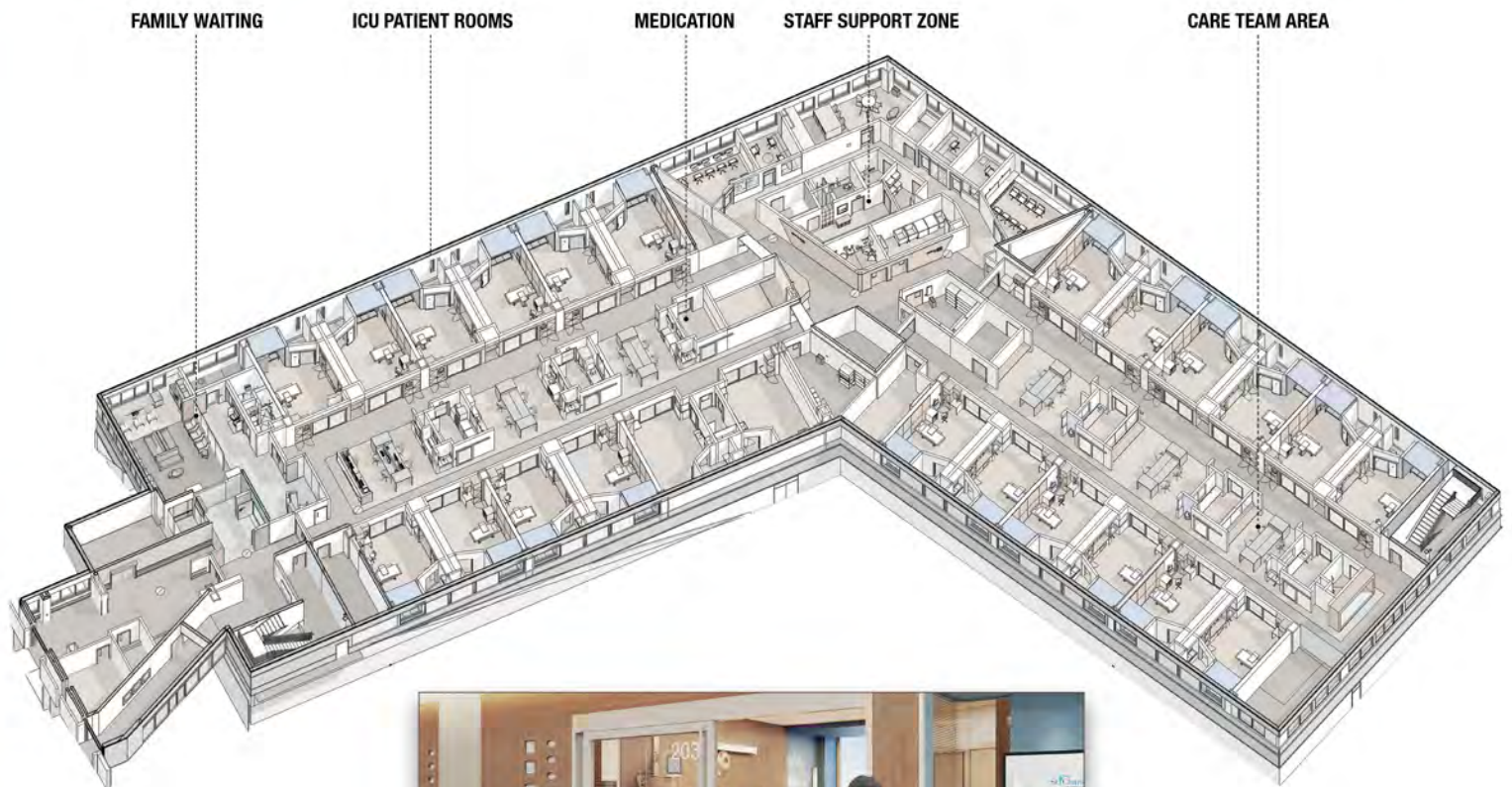

NEIGHBORHOODS OF CARE

- Team collaboration
- Excellent observation
- Open hallways
- Medication space

PATIENT AND FAMILY FOCUSED

- Rooms with space for family and shower
- Two family waiting areas
- Kitchenette
- Kids play area

CAREGIVER ENHANCEMENTS

- Team conference
- Respite area
- Efficient “off-stage” area
- In-room equipment storage